

Wind vane direction sensor

Model ES-W300S



Introduction

ES-W300S Wind vane direction sensor is used to measure the direction value of wind and convert it into electrical signal, which can be directly transmitted to the recording equipment for processing.

The sensor shell is made of aluminum, with very small dimensional tolerance, high surface accuracy, high weather resistance, high strength, corrosion resistance and water resistance; the internal circuit has been protected, and the whole sensor has good adaptability to harsh environment. The cable connector is a military plug, which has good anti-corrosion and anti-corrosion performance, can ensure the long-term use of the instrument, and cooperate with the internal imported bearing system to ensure the accuracy of wind direction collection.

Application

It is widely used in the fields of construction machinery (cranes, crawler cranes, gantry cranes, tower cranes, etc.), as well as wind speed measurement in fields such as railways, ports, docks, power plants, meteorology, cableways, environment, aquaculture, air conditioning, energy-saving monitoring, agriculture, etc.

Dimension

Unit:mm

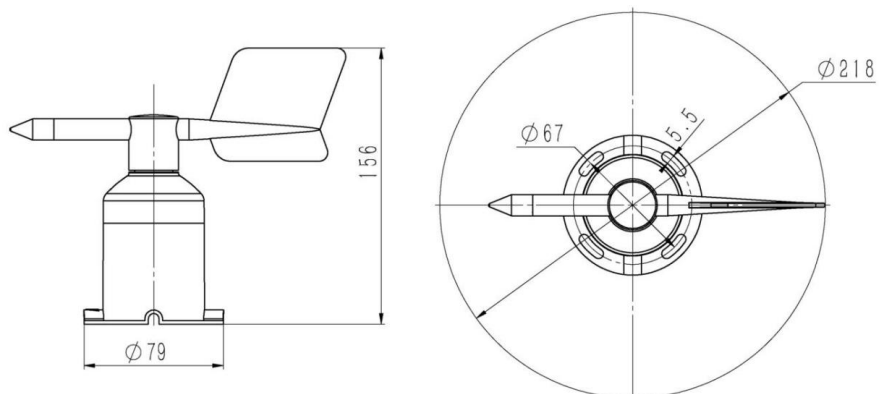

Main features

- Imported chips, high-precision and stable performance
- Polycarbon/aluminum alloy two materials are available
- Bottom outlet, waterproof and anti-corrosion
- Optional heating function to cope with bad weather
- Low rotation resistance, can work with breeze

Compliance

The electromagnetic compatibility in accordance with the following applicable directives:
 LVD 2014/35/EU Low Voltage
 EMC 2014/30/EU
 Electromagnetic Compatibility
 EMC 2014/35/EU
 Electromagnetic Compatibility

Specification

Measurement range	8-position/16-position/0-360 °
Accuracy	± 1 °
Resolution	0.1 °
Starting wind speed	≤ 0.3m/s
Maximum turning radius	100mm
Output signal	A: Analog signal (0-2v, 0-5V, 0-10V), 4-20mA (current loop) B: SDI-12 (American Hydrological Organization Serial Data Communication Interface Protocol) C: RS485 (standard Modbus RTU protocol, device default address: 01) D: Lora/Wifi/4G
Supply voltage	5-24vdc (when the output signal is 0-2v, RS485) 12-24vdc (when the output signal is 0-5V, 0-10V, 4-20mA)
Working environment	0 °C ~ 50 °C (Not heated type), -30 °C ~ 75 °C(Heated type)
Humidity	≤ 100% RH
Protection grade	IP65
Material	aluminum
Power consumption	Heater off: 24V/8mA; Heater on: 160mA@12V;310mA@24V
Heating functions optional	PTC automatic heating (only for heating model)
Automatic heating	Bellow -1 °C , reach 25 °C automatically stop heating

Order guide

ES-W300S	Wind vane direction sensor		
	CODE	Material	
	Y	With heating function	
	N	Without heating function	
		CODE	Signal output
		1	4~20mA
		2	0-10V
		3	0-5V
		4	RS485
		5	Lora
		6	4G
		7	WIFI
ES-W300S	N	1	Order example